



No. 20 Tee



No. 10 Elbow

**1.0 PRODUCT DESCRIPTION**

**Available Sizes**

- ¾ – 60"/DN20 – DN1500

**Maximum Working Pressure**

- Pressure ratings for Victaulic standard fittings conform to the ratings of Victaulic Style 177N couplings (refer to [publication 06.24](#) for more information).

**Application**

- Connects pipe, provides change in direction and adapts sizes or components
- Supplied with Victaulic OGS grooves
- Exclusively for use with Victaulic couplings, valves, accessories and pipe which feature ends formed with the Victaulic OGS groove profile

**Pipe Materials**

- Carbon steel or stainless steel

**NOTE**

- These fittings are not intended for use with Victaulic plain end couplings. Intended for use only in grooved piping systems. When connecting wafer or lug type butterfly valves directly to Victaulic fittings using Style 741 or Style 743 flange adapters, be sure to check disc clearance dimensions with I.D. dimension of fitting.

**ALWAYS REFER TO ANY NOTIFICATIONS AT THE END OF THIS DOCUMENT REGARDING PRODUCT INSTALLATION, MAINTENANCE OR SUPPORT.**

System No.		Location	
Submitted By		Date	

Spec Section		Paragraph	
Approved		Date	

## 1.0 PRODUCT DESCRIPTION (Continued)

### Other Fitting Styles



AGS - Advanced Groove System  
from 14 – 60"/DN350 – DN1500  
[Publication 20.05](#)



Ductile Iron for AWWA size pipe  
[Publication 23.05](#)



Stainless Steel  
[Publication 17.16](#)



XL fittings for abrasive services  
[Publication 07.07](#)



Galvanized  
[Publication 07.01](#) for Original Groove Fittings  
[Publication 20.05](#) for AGS Fittings



Aluminum  
[Publication 21.03](#)



Extra Heavy EndSeal "ES"  
[Publication 07.03](#)



Shouldered Ends  
[Publication 07.06](#)



Copper  
[Publication 22.04](#)



Plain End  
[Publication 14.04](#)

---

## 2.0 CERTIFICATION/LISTINGS

---



### NOTES

- When supplied as “hot dip galvanized” the following fittings are UL Classified in accordance with ANSI/NSF 61 and for use on cold +86°F/+30°C potable water service and ANSI/NSF 372: No. 10 90° Elbow, No. 11 45° Elbow, No. 12 22 ½° Elbow, No. 13 11 ¼° Elbow, No. 100 90° Long Radius Elbow, No. 110 45° Long Radius Elbow, No. 20 Tee, No. 25 Tee with Grooved Branch, No. 30 45° Lateral, No. 60 Cap, No. 50 Concentric Reducers, No. 51 Eccentric Reducers.
- The following Victaulic fittings are VdS approved: No.10 90° Elbow, No.11 45° Elbow, No.20 Tee and No.60 Cap.
- The following Victaulic fittings are LPCB approved: No.10 90° Elbow, No.11 45° Elbow, No.12 22 ½° Elbow, No.13 11 ¼° Elbow, No.30 45° Lateral, No.30-R Reducing Lateral, No.100 Long Radius Elbow, No.110 Long Radius Elbow, No.20 Tee, No.35 Cross, No.60 Cap, No.25 Reducing Tee, No.33 True Wye, No.50 Concentric Reducer, No.51 Eccentric Reducer and No.29M Tee with Threaded Branch.
- The following Victaulic fittings are FM approved: No.10 90° Elbow, No.11 45° Elbow, No.12 22 ½° Elbow, No.13 11 ¼° Elbow, No.30 45° Lateral, No.100 Long Radius Elbow, No.20 Tee, No.35 Cross, No.60 Cap, No.25 Reducing Tee and No.50 Concentric Reducer.

---

## 3.0 SPECIFICATIONS - MATERIAL

---

### Fitting: (specify choice)

Standard: Ductile iron conforming to ASTM A536, Grade 65-45-12.

Optional: Segmentally welded steel as shown under nipples

### Nipples: (specify choice)

¾ – 4"/DN20 – DN100: Carbon steel, Schedule 40, conforming to ASTM A53, Type F

5 – 6"/DN125 – DN150: Carbon steel, Schedule 40, conforming to ASTM A53, Type E or S, Gr. B

8 – 12"/DN200 – DN300: Carbon steel, Schedule 30 or 40, conforming to ASTM A53, Type E or S, Gr. B

### Flanged Adapter Nipples: (specify choice)

Class 125 Flange: Cast iron conforming to ANSI B16.1

Class 150 Flange: Carbon steel conforming to ANSI B16.5, raised or flat face

Class 300 Flange: Carbon steel conforming to ANSI B16.5, raised or flat face

### Fitting Coating: (specify choice)

Standard: Orange enamel

Optional: Hot dip galvanized and others. Some fittings supplied electroplated as standard – see product specifications

### Flanged Adapter Nipple Coating: (specify choice)

Standard: None (Unfinished)

Optional: Orange enamel, hot dip galvanized and others

## 4.0 DIMENSIONS

### Elbows

**No. 10** 90° Elbow

**No. 11** 45° Elbow

**No. 12** 22½° Elbow

**No. 13** 11¼° Elbow

**No. 100** 90° Long Radius Elbow

**No. 110** 45° Long Radius Elbow

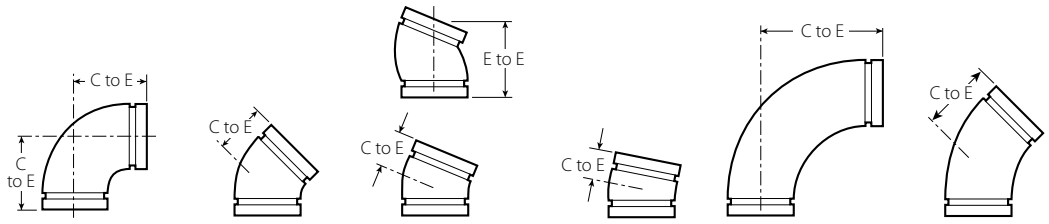

Standard and GSNK

Size		No. 10 90° Elbow		No. 11 45° Elbow		No. 12 22½° Elbow		No. 13 11¼° Elbow		No. 100 90° Long Radius Elbow		No. 110 45° Long Radius Elbow	
Nominal	Actual Outside Diameter	C to E	Approx. Wgt. (Each)	C to E	Approx. Wgt. (Each)	C to E	Approx. Wgt. (Each)	C to E	Approx. Wgt. (Each)	C to E	Approx. Wgt. (Each)	C to E	Approx. Wgt. (Each)
inches DN	inches mm	inches mm	lb kg	inches mm	lb kg	inches mm	lb kg	inches mm	lb kg	inches mm	lb kg	inches mm	lb kg
¾ DN20	1.050 26.9	2.25 57	0.5 0.2	1.50 38	0.5 0.2	1.63 (sw) 41	—	1.38 (sw) 35	—	2.50 (sw) 64	0.4 0.2	1.88 (sw) 48	0.3 0.1
1 DN25	1.315 33.7	2.25 57	0.6 0.3	1.75 44	0.6 0.3	3.25 <sup>1</sup> 83	0.6 0.3	1.38 (sw) 35	0.3 0.1	2.88 (sw) 73	0.6 0.3	2.25 (sw) 57	0.5 0.2
1¼ DN32	1.660 42.4	2.75 70	1.0 0.5	1.75 44	0.9 0.4	1.75 44	0.8 0.4	1.38 (sw) 35	0.5 0.2	3.25 (sw) 83	1.1 0.5	2.38 (sw) 60	0.7 0.3
1½ DN40	1.900 48.3	2.75 70	1.2 0.5	1.75 44	0.9 0.4	1.75 44	0.8 0.4	1.38 (sw) 35	0.5 0.2	3.63 (sw) 92	2.2 1.0	2.50 (sw) 64	1.3 0.6
2 DN50	2.375 60.3	3.25 83	1.8 0.8	2.00 51	1.3 0.6	1.88 48	1.2 0.5	1.38 35	1.0 0.5	4.38 111	2.5 1.1	2.75 70	1.8 0.8
2½ DN65	2.875 73.0	3.75 95	3.2 1.5	2.25 57	2.2 1.0	4.00 <sup>1</sup> 102	2.3 1.0	1.50 38	1.1 0.5	5.13 130	3.4 1.5	3.00 76	2.8 1.3
3 DN80	3.000 76.1	3.75 95	3.7 1.7	2.25 57	3.4 1.5	2.25 57	—	1.50 38	—	—	—	—	—
3½ DN90	3.500 88.9	4.25 108	4.5 2.0	2.50 64	3.1 1.4	4.50 <sup>1</sup> 114	3.1 1.4	1.50 38	2.1 1.0	5.88 149	6.0 2.7	3.38 86	4.9 2.2
4 DN100	4.000 101.6	4.50 114	5.6 2.5	2.75 70	4.3 2.0	2.50 (sw) 64	4.0 1.8	1.75 (sw) 44	2.7 1.2	—	—	—	—
	4.500 114.3	5.00 127	7.1 3.2	3.00 76	5.6 2.5	2.88 73	5.6 2.5	1.75 44	3.6 1.6	7.50 191	12.3 5.6	4.00 102	7.3 3.3
	4.250 108.0	5.00 127	11.0 5.0	3.00 76	5.6 2.5	—	—	—	—	—	—	—	—
	5.000 127.0	5.25 (sw) 133	10.0 4.5	3.13 (sw) 79	6.0 2.7	3.50 (sw) 89	6.6 3.0	1.88 (sw) 48	4.2 1.9	—	—	—	—
5	5.563 141.3	5.50 140	11.7 5.3	3.25 83	8.3 3.8	2.88 (sw) 73	7.8 3.5	2.00 (sw) 51	5.0 2.2	9.25 (sw) 235	18.0 8.2	4.88 (sw) 124	14.8 6.7
	5.250 133.0	5.50 140	11.7 5.3	3.25 83	8.3 3.8	—	—	—	—	—	—	—	—
DN125	5.500 139.7	5.50 140	11.7 5.3	3.25 83	8.3 3.8	2.88 73	—	2.00 51	—	—	—	—	—
6 DN150	6.625 168.3	6.50 165	17.2 7.8	3.50 89	10.8 4.9	6.25 <sup>1</sup> 159	12.2 5.5	2.00 51	7.0 3.2	10.75 273	30.4 13.8	5.50 140	17.4 7.9
	6.250 159.0	6.50 165	18.6 8.4	3.50 89	10.8 4.9	—	—	—	—	—	—	—	—
	6.500 165.1	6.50 165	15.5 7.0	3.50 89	9.8 4.4	3.13 79	11.4 5.2	2.00 51	7.4 3.4	10.75 (sw) 273	29.0 13.2	5.50 (sw) 140	19.0 8.6

<sup>1</sup> Gooseneck design, end-to-end dimension fittings in this size, contact your nearest Victaulic sales representative.

(s) = Carbon Steel Direct Roll Groove (OGS)

(sw) = Carbon Steel Segmentally Welded

### NOTE

- All fittings are ductile iron unless otherwise noted with an (sw) or (s).

## 4.0 DIMENSIONS (Continued)

### Elbows

No. 10 90° Elbow

No. 11 45° Elbow

No. 12 22½° Elbow

No. 13 11¼° Elbow

No. 100 90° Long Radius Elbow

No. 110 45° Long Radius Elbow

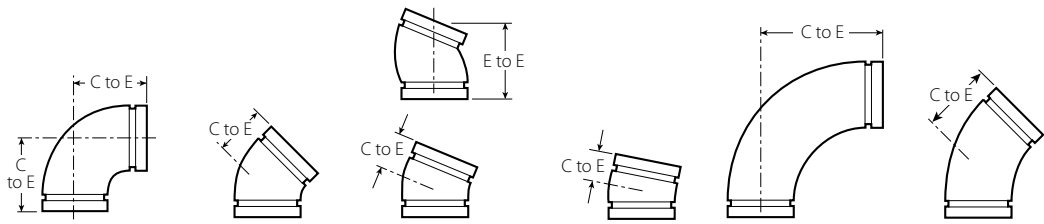

Standard and GSNK

Size		No. 10 90° Elbow		No. 11 45° Elbow		No. 12 22½° Elbow		No. 13 11¼° Elbow		No. 100 90° Long Radius Elbow		No. 110 45° Long Radius Elbow	
Nominal	Actual Outside Diameter	C to E	Approx. Wgt. (Each)	C to E	Approx. Wgt. (Each)	C to E	Approx. Wgt. Each	C to E	Approx. Wgt. (Each)	C to E	Approx. Wgt. (Each)	C to E	Approx. Wgt. (Each)
inches DN	inches mm	inches mm	lb kg	inches mm	lb kg	inches mm	lb kg	inches mm	lb kg	inches mm	lb kg	inches mm	lb kg
8 DN200	8.625 219.1	7.75 197	29.9 13.6	4.25 108	20.4 9.3	7.75 <sup>1</sup> 197	20.0 9.1	2.00 51	10.1 4.6	14.25 362	66.0 30.0	7.25 184	36.0 16.3
10 DN250	10.750 273.0	9.00 229	63.3 28.7	4.75 121	37.5 17.0	4.38 (sw) 111	30.0 13.6	2.13 54	11.8 5.3	15.00 381	107.0 48.5	6.25 159	57.0 25.9
12 DN300	12.750 323.9	10.00 254	74.0 33.6	5.25 133	66.7 30.3	4.88 (sw) 124	40.0 18.1	2.25 57	29.3 13.3	18.00 457	156.0 70.8	7.50 191	90.0 40.8
14 <sup>2</sup> DN350	14.000 355.6	14.00 356	136.0 61.7	5.75 146	65.0 29.5	5.00 (sw) 127	46.0 20.9	3.50 (sw) 89	32.0 14.5	21.00 (s) 533	164.0 74.4	8.75 222	82.0 37.2
	14.843 377.0	14.84 377	149.3 67.7	6.13 156	82.0 37.2	—	—	—	—	—	—	—	—
16 <sup>2</sup> DN400	16.000 406.5	16.00 406	171.0 77.6	6.63 168	88.0 39.3	5.00 (sw) 127	58.0 26.3	4.00 (sw) 102	42.0 19.1	24.00 (s) 610	210.0 95.3	10.00 (s) 254	100.0 45.4
	16.773 426.0	16.75 425	198.6 90.1	7.00 178	101.3 45.9	—	—	—	—	—	—	—	—
18 <sup>2</sup> DN450	18.000 457.2	18.00 457	228.0 103.4	7.50 190	108.0 50.0	5.50 (sw) 140	65.0 29.5	4.50 (sw) 144	53.2 24.1	27.00 (s) 686	273.0 123.8	11.25 (s) 286	135.0 61.2
	18.898 480.0	18.88 480	291.0 132.0	7.83 200	141.7 64.3	—	—	—	—	—	—	—	—
20 <sup>2</sup> DN500	20.000 508.0	20.00 508	298.0 135.2	8.25 210	138.0 62.6	6.00 (sw) 152	78.6 36.0	5.00 (sw) 127	65.0 29.5	30.00 (s) 762	343.0 155.6	12.50 (s) 318	174.0 78.9
	20.866 530.0	20.88 530	355.0 161.0	8.63 219	179.0 81.2	—	—	—	—	—	—	—	—
24 <sup>2</sup> DN600	24.000 609.6	24.00 610	438.0 198.7	10.00 254	221.0 100.2	7.00 (sw) 178	140.0 63.5	6.00 (sw) 152	60.0 27.2	36.00 (s) 914	516.0 234.1	15.00 (s) 381	251.0 113.9
	24.803 630.0	24.80 630	545.0 247.2	10.25 261	255.2 115.7	—	—	—	—	—	—	—	—
14 – 60 DN350 – DN1500	For AGS fitting information, see <a href="#">publication 20.05</a>												

<sup>1</sup> Gooseneck design, end-to-end dimension fittings in this size, contact your nearest Victaulic sales representative.

<sup>2</sup> For 14"/DN350 and larger roll grooved systems, Victaulic offers the Advanced Groove System (AGS). For pricing and availability of cut groove fittings in this size, contact your nearest Victaulic sales representative.

(s) = Carbon Steel Direct Roll Groove (OGS)

(sw) = Carbon Steel Segmentally Welded

### NOTE

- All fittings are ductile iron unless otherwise noted with an (sw) or (s).

## 4.1 DIMENSIONS

### Reducing Base Support Elbow

No. R-10G Grv. x Grv.

No. R-10F Grv. x Flange

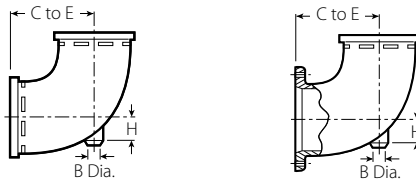

Size		No. R-10 Reducing Base Support Elbow			Approx. Weight Each		
Nominal inches DN	x	C to E inches mm	H inches mm	B Diameter inches mm	Grv. x Grv. lb kg	Grv. x Flange lb kg	
6 DN150	x	4 DN100	9.00 229	1.25 32	1.50 38	19.0 8.6	33.0 15.0
		5	9.00 229	1.50 38	1.50 38	23.0 10.4	38.0 17.2
8 DN200	x	6 DN150	10.50 267	2.13 24	1.50 38	33.0 15.0	52.0 23.6
10 DN250	x	8 DN200	12.00 305	2.40 61	1.50 38	61.0 27.7	88.0 39.9

## 4.2 DIMENSIONS

### Adapter Elbow

No. 18 90° Adapter Elbow

No. 19 45° Adapter Elbow

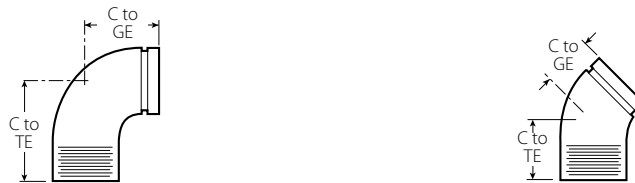

Size		No. 18 90° Adapter Elbow			No. 19 45° Adapter Elbow		
Nominal inches DN	Actual Outside Diameter inches mm	C to GE inches mm	C to TE inches mm	Approximate Weight (Each) lb kg	C to GE inches mm	C to TE inches mm	Approx. Weight (Each) lb kg
¾ DN20	1.050 26.9	2.25 57	2.25 57	0.5 0.2	1.50 38	1.50 38	0.5 0.2
1 DN25	1.315 33.7	2.25 57	2.25 57	0.5 0.2	—	—	—
1¼ DN32	1.660 42.4	2.75 70	2.75 70	0.9 0.4	—	—	—
1½ DN40	1.900 48.3	2.75 70	2.75 70	1.1 0.5	1.75 44	1.75 44	0.9 0.4
2 DN50	2.375 60.3	3.25 83	4.25 108	2.5 1.1	—	—	—
2½	2.875 73.0	3.75 95	3.75 95	3.0 1.4	2.25 57	2.25 57	2.3 1.0
3 DN80	3.500 88.9	4.25 108	6.00 152	5.8 2.6	2.50 64	4.25 108	5.0 2.3
3½ DN90	4.000 101.6	4.50 114	6.25 159	8.0 3.6	5.25 133	5.25 133	8.8 4.0
6 DN150	6.625 168.3	6.50 165	6.50 165	17.6 8.0	3.50 89	3.50 89	12.7 5.8

**NOTE**

- Available with British Standard Pipe Threads, specify "BSP" clearly on order.

### 4.3 DIMENSIONS

#### Tees, Crosses and True Wyes

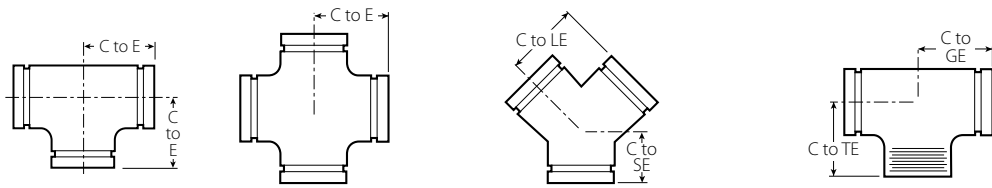

Size		No. 20 Tee		No. 35 Cross (sw)		No. 33 True Wye (sw)			No. 29M Tee with Threaded Branch		
Nominal inches DN	Actual Outside Diameter inches mm	C to E inches mm	Approx. Weight (Each) lb kg	C to E inches mm	Approx. Weight (Each) lb kg	C to LE inches mm	C to SE inches mm	Approx. Weight (Each) lb kg	C to GE inches mm	C to TE inches mm	Approx. Weight (Each) lb kg
3/4 DN20	1.050 26.9	2.25 57	0.6 0.3	2.25 57	0.9 0.4	2.25 57	2.00 51	0.7 0.3	2.25 57	2.25 (sw) 57	0.6 0.3
1 DN25	1.315 33.7	2.25 57	1.0 0.5	2.25 57	1.3 0.6	2.25 57	2.25 57	1.1 0.5	2.25 57	2.25 57	1.0 0.5
1 1/4 DN32	1.660 42.4	2.75 70	1.5 0.7	2.75 70	2.1 1.0	2.75 70	2.50 64	1.5 0.7	2.75 70	2.75 70	1.5 0.7
1 1/2 DN40	1.900 48.3	2.75 70	2.0 0.9	2.75 70	2.5 1.1	2.75 70	2.75 70	1.8 0.8	2.75 70	2.75 70	2.0 0.9
2 DN50	2.375 60.3	3.25 83	3.0 1.4	3.25 83	3.8 1.7	3.25 83	2.75 70	2.5 1.1	3.25 83	4.25 108	3.0 1.4
2 1/2 DN65	2.875 73.0	3.75 95	4.3 2.0	3.75 95	6.1 2.8	3.75 95	3.00 76	4.3 2.0	3.75 95	3.75 95	4.3 2.0
3 DN80	3.500 88.9	4.25 108	6.8 3.0	4.25 108	10.5 4.8	4.25 108	3.25 83	6.1 2.8	4.25 108	6.00 152	6.8 3.1
3 1/2 DN90	4.000 101.6	4.50 (sw) 114	7.9 3.6	4.50 114	11.5 5.2	4.50 114	3.50 89	9.6 4.4	4.50 114	4.50 (sw) 114	7.9 3.6
4 DN100	4.250 108.0	5.00 127	15.5 7.0	—	—	—	—	—	5.00 127	5.00 (sw) 127	15.5 7.0
4 DN100	4.500 114.3	5.00 127	11.9 5.4	5.00 127	15.8 7.2	5.00 127	3.75 95	9.8 4.4	5.00 127	7.25 184	11.9 5.4
5 DN125	5.000 127.0	5.25 (sw) 133	15.0 6.8	5.25 133	18.5 8.4	—	—	—	5.25 133	5.25 (sw) 133	15.0 6.8
5 DN125	5.250 133.0	5.50 140	17.8 8.1	—	—	—	—	—	5.50 140	5.50 (sw) 140	17.8 8.1
5 DN125	5.500 139.7	5.50 140	17.8 8.1	—	—	—	—	—	5.50 140	5.50 (sw) 140	17.8 8.1
5 DN125	5.563 141.3	5.50 140	17.8 8.1	5.50 140	20.0 9.1	5.50 140	4.00 102	15.0 6.8	5.50 140	5.50 (sw) 140	17.8 8.1
6 DN150	6.250 159.0	6.50 165	27.1 12.3	—	—	—	—	—	6.50 165	6.50 (sw) 165	27.1 12.3
6 DN150	6.500 165.1	6.50 165	22.0 10.0	6.50 165	28.0 12.7	—	—	—	6.50 165	6.50 (sw) 165	22.0 10.0
6 DN150	6.625 168.3	6.50 165	25.7 11.7	6.50 165	28.0 12.7	6.50 165	4.50 114	22.3 10.1	6.50 165	6.50 (sw) 165	25.7 11.7
8 DN200	8.625 219.1	7.75 197	47.6 21.6	7.75 197	48.0 21.8	7.75 197	6.00 152	36.0 16.3	7.75 197	7.75 197	47.6 21.6
10 DN250	10.750 273.0	9.00 229	99.0 44.9	9.00 229	121.5 55.1	9.00 229	6.50 155	69.9 31.7	9.00 229	9.00 229	99.0 44.9
12 DN300	12.750 323.9	10.00 254	133.0 60.3	10.00 254	110.0 49.9	10.00 254	7.00 178	80.0 36.3	10.00 254	10.00 254	133.0 60.3

(s) = Carbon Steel Direct Roll Groove (OGS)

(sw) = Carbon Steel Segmentally Welded

**NOTE**

- All fittings are ductile iron unless otherwise noted with an (sw) or (s).

### 4.3 DIMENSIONS (Continued)

#### Tees, Crosses and True Wyes

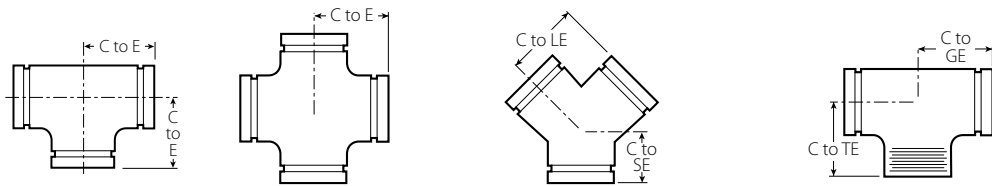

Size		No. 20 Tee		No. 35 Cross (sw)		No. 33 True Wye (sw)			No. 29M Tee with Threaded Branch		
Nominal inches DN	Actual Outside Diameter inches mm	C to E inches mm	Approx. Weight (Each) lb kg	C to E inches mm	Approx. Weight (Each) lb kg	C to LE inches mm	C to SE inches mm	Approx. Weight (Each) lb kg	C to GE inches mm	C to TE inches mm	Approx. Weight (Each) lb kg
14 <sup>2</sup> DN350	14.000 355.6	11.00 (sw) 279	145.0 65.8	11.00 279	198.0 89.8	11.00 279	7.50 191	134.2 60.8	—	—	—
	377.0	11.50 292	145.0 65.8	—	—	—	—	—	—	—	—
16 <sup>2</sup> DN400	16.000 406.4	12.00 (sw) 305	186.0 84.4	12.00 305	250.0 113.4	12.00 305	8.00 203	167.0 75.7	—	—	—
	426.0	13.00 300	186.0 84.4	—	—	—	—	—	—	—	—
18 <sup>2</sup> DN450	18.000 457.0	15.50 (sw) 394	260.0 117.9	15.50 394	350.0 158.8	15.50 394	8.50 216	234.0 106.1	—	—	—
	480.0	14.63 372	256.0 116.1	—	—	—	—	—	—	—	—
20 <sup>2</sup> DN500	20.000 508.0	17.25 (sw) 438	336.0 152.4	17.25 438	452.0 205.0	17.25 438	9.00 229	281.0 127.5	—	—	—
	530.0	15.38 (sw) 391	339.0 153.8	—	—	—	—	—	—	—	—
24 <sup>2</sup> DN600	24.000 610.0	20.00 (sw) 508	592.0 268.5	20.00 508	795.0 360.6	20.00 508	10.00 254	523.0 237.2	—	—	—
	630.0	17.38 (sw) 441	473.0 214.5	—	—	—	—	—	—	—	—
14 – 60 DN350 – DN1500	For AGS fitting information, see <a href="#">publication 20.05</a> 										

<sup>2</sup> For 14"/DN350 and larger roll grooved systems, Victaulic offers the Advanced Groove System (AGS). For pricing and availability of cut groove fittings in this size, contact your nearest Victaulic sales representative.

(s) = Carbon Steel Direct Roll Groove (OGS)

(sw) = Carbon Steel Segmentally Welded

**NOTE**

- All fittings are ductile iron unless otherwise noted with an (sw) or (s).



## 4.4 DIMENSIONS

### Reducing Tee

No. 25 Grooved Branch

No. 29T Threaded Branch

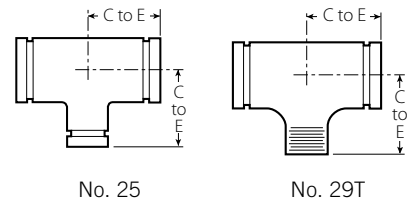
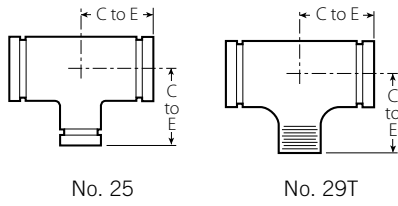

Size			No. 25 Std.	No. 29T w/ Thd. Branch	Approx. Weight (Each) lb kg	
Nominal inches DN			C to E inches mm	C to E inches mm		
1 DN25	x	1 DN25	2.25 (sw) 57	2.25 (sw) 57	1.0 0.5	
1 1/4 DN32	x	1 1/4 DN32	2.75 (sw) 70	2.75 (sw) 70	1.3 0.6	
1 1/2 DN40	x	1 1/2 DN40	3/4 DN20	2.75 (sw) 70	2.75 (sw) 70	1.5 0.7
			1 DN25	2.75 (sw) 70	2.75 (sw) 70	1.5 0.7
			1 1/4 DN32	2.75 (sw) 70	2.75 (sw) 70	1.7 0.8
2 DN50	x	2 DN50	3/4 DN20	3.25 83	3.25 83	2.5 1.1
			1 DN25	3.25 83	3.25 83	2.7 1.2
			1 1/4 DN32	3.25 (sw) 83	3.25 (sw) 83	1.8 0.8
			1 1/2 DN40	3.25 83	3.25 (sw) 83	3.0 1.4
2 1/2	x	2 1/2	3/4 DN20	3.75 (sw) 95	3.75 (sw) 95	3.9 1.8
			1 DN25	3.75 95	3.75 (sw) 95	3.8 1.7
			1 1/4 DN32	3.75 95	3.75 95	4.2 1.7
			1 1/2 DN40	3.75 95	3.75 95	3.9 1.8
			2 DN50	3.75 95	3.75 (sw) 95	4.5 2.0
3 DN80	x	3 DN80	3/4 DN20	4.25 (sw) 108	4.25 (sw) 108	5.7 2.6
			1 DN25	4.25 108	4.25 108	6.1 2.8
			1 1/4 DN32	4.25 108	4.25 108	8.0 3.6
			1 1/2 DN40	4.25 108	4.25 (sw) 108	6.5 2.9
			2 DN50	4.25 108	4.25 (sw) 108	6.2 2.8
			2 1/2	4.25 108	4.25 (sw) 108	6.4 2.9

(s) = Carbon Steel Direct Roll Groove (OGS)

(sw) = Carbon Steel Segmentally Welded

**NOTE**

- Cast fitting available. Contact Victaulic for details.

Size			No. 25 Std.	No. 29T w/ Thd. Branch	Approx. Weight (Each) lb kg				
Nominal inches DN			C to E inches mm	C to E inches mm					
4 DN100	x	4 DN100	3/4 DN20	5.00 (sw) 127	5.00 (sw) 127	8.0 3.6			
			1 DN25	5.00 127	5.00 127	7.8 3.5			
			1 1/4 DN32	5.00 (sw) 127	5.00 (sw) 127	9.6 4.4			
			1 1/2 DN40	5.00 127	5.00 127	10.2 4.6			
			2 DN50	5.00 127	5.00 127	11.2 5.1			
			2 1/2	5.00 127	5.00 127	11.4 5.2			
			3 DN80	5.00 127	5.00 127	11.6 5.3			
			5	x	5	1 DN25	5.50 (sw) 140	5.50 (sw) 140	14.0 6.4
						1 1/2 DN40	5.50 (sw) 140	5.50 (sw) 140	14.3 6.5
						2 DN50	5.50 (sw) 140	5.50 (sw) 140	14.5 6.6
2 1/2	5.50 140	5.50 (sw) 140				15.2 6.9			
3 DN80	5.50 140	5.50 (sw) 140				16.6 7.5			
4 DN100	5.50 140	5.50 (sw) 140				16.7 7.6			
6 DN150	x	6 DN150	1 DN25	6.50 (sw) 165	6.50 (sw) 165	23.0 10.4			
			1 1/2 DN40	6.50 (sw) 165	6.50 (sw) 165	24.0 10.9			
			2 DN50	6.50 165	6.50 165	21.6 9.8			
			2 1/2	6.50 165	6.50 165	21.4 11.7			
			3 DN80	6.50 165	6.50 165	26.5 12.0			
			4 DN100	6.50 165	6.50 165	25.0 11.3			
6 1/2	x	6 1/2	3 DN80	6.50 165	6.50 (sw) 165	24.0 10.9			
			4 DN100	6.50 165	6.50 (sw) 165	25.0 11.3			

(s) = Carbon Steel Direct Roll Groove (OGS)

(sw) = Carbon Steel Segmentally Welded

**NOTE**

- Cast fitting available. Contact Victaulic for details.

### 4.4 DIMENSIONS (Continued)

#### Reducing Tee

No. 25 Grooved Branch

No. 29T Threaded Branch

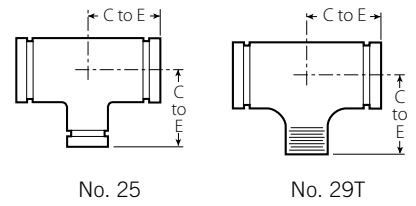
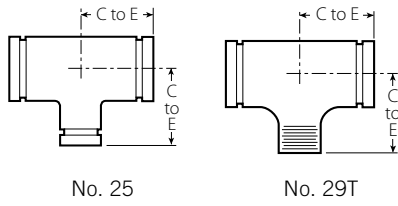

Size		No. 25 Std.	No. 29T w/ Thd. Branch	Approx. Weight (Each)	
Nominal inches DN		C to E inches mm	C to E inches mm	lb kg	
8 DN200 x 8 DN200	1 1/2 DN40	7.75 (sw) 197	7.75 (sw) 197	33.0 15.0	
	2 DN50	7.75 (sw) 197	7.75 (sw) 197	33.5 15.2	
	2 1/2	7.75 (sw) 197	7.75 (sw) 197	39.0 17.7	
	3 DN80	7.75 (sw) 197	7.75 (sw) 197	33.6 15.2	
	4 DN100	7.75 197	7.75 197	41.8 19.0	
	5	7.75 (sw) 197	7.75 (sw) 197	34.0 15.4	
	6 DN150	7.75 197	7.75 197	42.3 19.2	
	165.1mm	7.75 (sw) 197	7.75 (sw) 197	48.0 21.8	
	10 DN250 x 10 DN250	1 1/2 DN40	9.00 229	9.00 229	62.0 28.1
		2 DN50	9.00 (sw) 229	9.00 (sw) 229	62.0 28.1
2 1/2		9.00 (sw) 229	9.00 (sw) 229	62.4 28.3	
3 DN80		9.00 (sw) 229	9.00 (sw) 229	60.0 27.2	
4 DN100		9.00 (sw) 229	9.00 (sw) 229	61.0 27.7	
5		9.00 (sw) 229	9.00 (sw) 229	52.0 23.6	
6 DN150		9.00 (sw) 229	9.00 (sw) 229	59.0 26.8	
8 DN200		9.00 (sw) 229	9.00 (sw) 229	64.7 29.3	

(s) = Carbon Steel Direct Roll Groove (OGS)

(sw) = Carbon Steel Segmentally Welded

**NOTE**

- Cast fitting available. Contact Victaulic for details.

Size		No. 25 Std.	No. 29T w/ Thd. Branch	Approx. Weight (Each)	
Nominal inches DN		C to E inches mm	C to E inches mm	lb kg	
12 DN300 x 12 DN300	1 DN25	10.00 (sw) 254	10.00 (sw) 254	77.0 34.9	
	2 DN50	10.00 (sw) 254	10.00 (sw) 254	80.0 36.3	
	2 1/2	10.00 (sw) 254	10.00 (sw) 254	78.0 35.4	
	3 DN80	10.00 (sw) 254	10.00 (sw) 254	82.0 37.2	
	4 DN100	10.00 (sw) 254	10.00 (sw) 254	80.0 36.3	
	5	10.00 (sw) 254	10.00 (sw) 254	75.0 34.0	
	6 DN150	10.00 (sw) 254	10.00 (sw) 254	75.0 34.0	
	8 DN200	10.00 (sw) 254	10.00 (sw) 254	80.0 36.3	
	10 DN250	10.00 (sw) 254	10.00 (sw) 254	84.0 38.1	
	14 <sup>2</sup> DN350 x 14 DN350	4 DN100	11.00 (sw) 279	11.00 (sw) 279	102.0 46.3
6 DN150		11.00 (sw) 279	11.00 (sw) 279	108.2 49.1	
8 DN200		11.00 279	11.00 279	112.0 50.8	
10 DN250		11.00 279	11.00 279	120.0 54.4	
12 DN300		11.00 279	11.00 279	129.1 58.6	
16 <sup>2</sup> DN400 x 16 DN400		4 DN100	12.00 305	12.00 305	130.0 59.0
		6 DN150	12.00 (sw) 305	12.00 (sw) 305	133.5 60.6
		8 DN200	12.00 305	12.00 305	145.0 65.8
	10 DN250	12.00 305	12.00 305	149.5 67.8	
	12 DN300	12.00 305	12.00 305	154.0 69.9	
	14 DN350	12.00 (sw) 305	—	167.0 75.8	

<sup>2</sup> For 14"/DN350 and larger roll grooved systems, Victaulic offers the Advanced Groove System (AGS). For pricing and availability of cut groove fittings in this size, contact your nearest Victaulic sales representative.

(s) = Carbon Steel Direct Roll Groove (OGS)

(sw) = Carbon Steel Segmentally Welded

**NOTE**

- Cast fitting available. Contact Victaulic for details.

## 4.4 DIMENSIONS (Continued)

### Reducing Tee

No. 25 Grooved Branch

No. 29T Threaded Branch

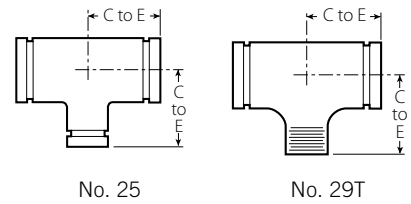
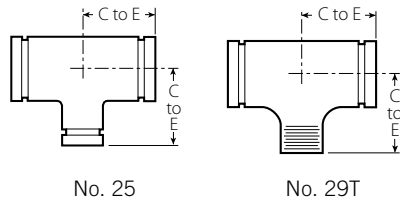

Size		No. 25 Std.	No. 29T w/ Thd. Branch	Approx. Weight (Each)			
Nominal inches	DN	C to E inches	C to E inches	lb			
		mm	mm	kg			
18 <sup>2</sup> DN450	x 18 DN450	4 DN100	15.50 (sw) 394	15.50 (sw) 394	194.0 88.0		
		6 DN150	15.50 (sw) 394	15.50 (sw) 394	200.0 90.7		
		8 DN200	15.50 (sw) 394	15.50 (sw) 394	202.0 91.6		
		10 DN250	15.50 394	15.50 394	212.0 96.2		
		12 DN300	15.50 394	15.50 394	222.6 101.0		
		14 DN350	15.50 394	—	230.1 104.4		
		16 DN400	15.50 394	—	247.6 112.3		
		20 <sup>2</sup> DN500	x 20 DN500	6 DN150	17.25 438	17.25 438	240.0 108.9
				8 DN200	17.25 438	17.25 438	244.0 110.7
				10 DN250	17.25 438	17.25 438	256.0 116.1
12 DN300	17.25 438			17.25 438	264.0 119.8		
14 DN350	17.25 438			—	275.0 124.7		
16 DN400	17.25 438			—	288.6 130.9		
18 DN450	17.25 438			—	297.0 134.7		

Size	No. 25 Std.	No. 29T w/ Thd. Branch	Approx. Weight (Each)			
Nominal inches	C to E inches	C to E inches	lb			
DN	mm	mm	kg			
24 <sup>2</sup> DN600	x 24 DN600	8 DN200	20.00 508	20.00 508	340.0 154.2	
		10 DN250	20.00 508	20.00 508	343.9 156.0	
		12 DN300	20.00 508	20.00 508	352.8 160.0	
		14 DN350	20.00 508	—	360.0 163.3	
		16 DN400	20.00 508	—	378.0 171.5	
		18 DN450	20.00 508	—	380.0 172.4	
		20 DN500	20.00 508	—	373.0 169.2	
		14 – 60 DN350 – 1500			For AGS fitting information, see <a href="#">publication 20.05</a>	

<sup>2</sup> For 14"/DN350 and larger roll grooved systems, Victaulic offers the Advanced Groove System (AGS). For pricing and availability of cut groove fittings in this size, contact your nearest Victaulic sales representative.

(s) = Carbon Steel Direct Roll Groove (OGS)

(sw) = Carbon Steel Segmentally Welded

#### NOTES

- No. 29T Threaded Outlet Reducing Tees are supplied NPT and are available with British Standard threads. For British Standard specify "BSP" clearly on order.
- All fittings are ductile iron unless otherwise noted with an (sw) or (s).
- Cast fitting available. Contact Victaulic for details.

<sup>2</sup> For 14"/DN350 and larger roll grooved systems, Victaulic offers the Advanced Groove System (AGS). For pricing and availability of cut groove fittings in this size, contact your nearest Victaulic sales representative.

(s) = Carbon Steel Direct Roll Groove (OGS)

(sw) = Carbon Steel Segmentally Welded

#### NOTE

- Cast fitting available. Contact Victaulic for details.

## 4.5 DIMENSIONS

### Bull Plug

#### No. 61

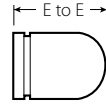

No. 61

Size		No. 61 Bull Plug (s)	
Nominal inches DN	Actual Outside Diameter inches mm	E to E inches mm	Approx. Weight (Each) lb kg
2 DN50	2.375 60.3	4.00 102	2.5 1.1
2 ½	2.875 73.0	5.00 127	3.0 1.4
3 DN80	3.500 88.9	6.00 152	4.5 2.0
4 DN100	4.500 114.3	7.00 178	7.5 3.4
5	5.563 141.3	8.00 203	12.0 5.4
6 DN150	6.625 168.5	10.00 254	17.0 7.7

(s) = Carbon Steel Direct Roll Groove (OGS)

(sw) = Carbon Steel Segmentally Welded

#### NOTES

- Steel dish caps available through 24"/DN600, contact Victaulic.
- No. 61 Bull Plugs should be used in vacuum service with Style 72 or 750 couplings.
- All fittings are ductile iron unless otherwise noted with an (sw) or (s).

## 4.6 DIMENSIONS

### 45° Lateral

#### No. 30

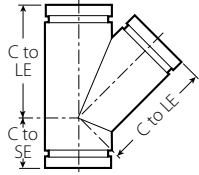

No. 30

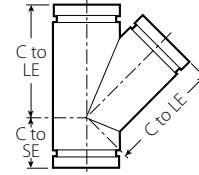

No. 30

Size		No. 30 45° Lateral		Weight
Nominal inches DN	Actual Outside Diameter inches mm	C to LE inches mm	C to SE inches mm	Approx. (Each) lb kg
¾ DN20	1.050 26.9	4.50 (sw) 114	2.00 (sw) 51	1.0 0.5
1 DN25	1.315 33.7	5.00 (sw) 127	2.25 (sw) 57	1.7 0.8
1¼ DN32	1.660 42.4	5.75 146	2.50 64	2.5 (d) 1.1
1½ DN40	1.900 48.3	6.25 (sw) 159	2.75 (sw) 70	3.5 1.6
2 DN50	2.375 60.3	7.00 (sw) 178	2.75 (sw) 70	5.0 2.3
2½	2.875 73.0	7.75 (sw) 197	3.00 (sw) 76	9.0 4.1
DN65	3.000 76.1	8.50 (sw) 216	3.25 (sw) 83	11.0 5.0
3 DN80	3.500 88.9	8.50 216	3.25 83	11.7 (d) 5.4
3½ DN90	4.000 101.6	10.00 (sw) 254	3.50 (sw) 89	17.8 8.1
4 DN100	4.500 114.3	10.50 267	3.75 95	22.2 (d) 10.1
5	5.563 141.3	12.50 (sw) 318	4.00 (sw) 102	21.8 9.9

(s) = Carbon Steel Direct Roll Groove (OGS)

(sw) = Carbon Steel Segmentally Welded

Size		No. 30 45° Lateral		Weight
Nominal inches DN	Actual Outside Diameter inches mm	C to LE inches mm	C to SE inches mm	Approx. (Each) lb kg
	6.500 165.1	14.00 (sw) 356	4.50 (sw) 114	43.6 19.8
6 DN150	6.625 168.3	14.00 (sw) 356	4.50 (sw) 114	43.6 49.8
8 DN200	8.625 219.1	18.00 (sw) 457	6.00 (sw) 152	72.0 32.7
10 DN250	10.750 273.0	20.50 (sw) 521	6.50 (sw) 165	105.0 47.6
12 DN300	12.750 323.9	23.00 (sw) 584	7.00 (sw) 178	165.0 74.8
14² DN350	14.000 355.6	26.50 (sw) 673	7.50 (sw) 191	276.0 125.2
16² DN400	16.000 406.4	29.00 (sw) 737	8.00 (sw) 203	344.2 156.1
18² DN450	18.000 457.0	32.00 (sw) 813	8.50 (sw) 216	429.0 194.6
20² DN500	20.000 508.0	35.00 (sw) 889	9.00 (sw) 229	500.0 226.8
24² DN600	24.000 610.0	40.00 (sw) 1016	10.00 (sw) 254	715.0 324.3
14 – 60 DN350 – DN1500	For AGS fitting information, see <a href="#">publication 20.05</a>			



<sup>2</sup> For 14"/DN350 and larger roll grooved systems, Victaulic offers the Advanced Groove System (AGS). For pricing and availability of cut groove fittings in this size, contact your nearest Victaulic sales representative.

(s) = Carbon Steel Direct Roll Groove (OGS)

(sw) = Carbon Steel Segmentally Welded

**NOTE**

- All fittings are ductile iron unless otherwise noted with an (sw) or (s).

## 4.7 DIMENSIONS

### 45° Reducing Lateral

#### No. 30-R

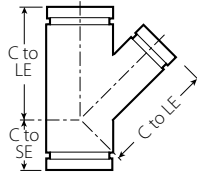

No. 30-R

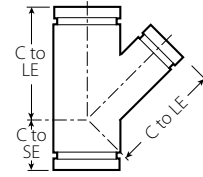

No. 30-R

Size			No 30-R 45° Reducing Lateral				
Nominal inches DN	x	Nominal inches DN	x	C to LE inches mm	C to SE inches mm	Approx. Weight (Each)	
						lb kg	
3 DN80	x	3 DN80	x	2 DN50	8.50 216	3.25 83	9.8
							4.4
4 DN100	x	4 DN100	x	2 DN50	10.50 267	3.75 95	10.0
							4.5
				2½	10.50 267	3.75 95	10.0
							4.5
3 DN80	10.50 267	3.75 95	18.3				
			8.3				
5	x	5	x	2 DN50	12.50 318	4.00 102	24.0
							10.9
				3 DN80	12.50 318	4.00 102	27.0
6 DN150	x	6 DN150	x	4 DN100	14.00 356	4.50 114	37.0
							16.8
				5	14.00 356	4.50 114	44.7
8 DN200	x	8 DN200	x	4 DN100	18.00 457	6.00 152	62.0
							28.1
				5	18.00 457	6.00 152	75.5
							34.2
6 DN150	18.00 457	6.00 152	82.0				
			37.2				
10 DN250	x	10 DN250	x	4 DN100	20.50 521	6.50 165	104.8
							47.5
				5	20.50 521	6.50 165	99.0
							44.9
6 DN150	20.50 521	6.50 165	105.8				
			48.0				
8 DN200	20.50 521	6.50 165	118.0				
			53.5				
12 DN300	x	12 DN300	x	5	23.00 584	7.00 178	122.0
							55.3
				6 DN150	23.00 584	7.00 178	137.0
							62.1
				8 DN200	23.00 584	7.00 178	147.0
66.7							
10 DN250	23.00 584	7.00 178	167.0				
75.8							

Size			No 30-R 45° Reducing Lateral				
Nominal inches DN	x	Nominal inches DN	x	C to LE inches mm	C to SE inches mm	Approx. Weight (Each)	
						lb kg	
14 <sup>2</sup> DN350	x	14 DN350	x	4 DN100	26.50 673	7.50	
						187.0	
				6 DN150	26.50 673	7.50 191	84.8
							205.8
				8 DN200	26.50 673	7.50 191	93.4
							235.0
10 DN250	26.50 673	7.50 191	106.6				
16 <sup>2</sup> DN400	x	16 DN400	x	6 DN150	29.00 737	8.00	
						215.0	
				8 DN200	29.00 737	8.00 203	252.5
							114.5
				10 DN250	29.00 737	8.00 203	265.0
							120.2
12 DN300	29.00 737	8.00 203	295.0				
			133.8				
14 DN350	29.00 737	8.00 203	305.0				
			138.3				
18 <sup>2</sup> DN450	x	18 DN450	x	6 DN150	32.00 813	8.50	
						274.0	
				8 DN200	32.00 813	8.50 216	275.0
							124.7
				12 DN300	32.00 813	8.50 216	347.0
							157.4
14 DN350	32.00 813	8.50 216	350.0				
			158.8				
16 DN400	32.00 813	8.50 216	362.0				
			164.2				
20 <sup>2</sup> DN500	x	20 DN500	x	12 DN300	35.00 889	9.00	
						415.0	
				14 DN350	35.00 889	9.00 229	420.0
							190.5
				16 DN400	35.00 889	10.00 229	425.0
							192.8
24 <sup>2</sup> DN600	x	24 DN600	x	16 DN400	40.00 1016	10.00	
						425.0	
20 DN600	40.00 1016	10.00 254	570.0				
			258.6				
14 – 60 DN350 – DN1500				For AGS fitting information, see <a href="#">publication 20.05</a> 			

<sup>2</sup> For 14"/DN350 and larger roll grooved systems, Victaulic offers the Advanced Groove System (AGS). For pricing and availability of cut groove fittings in this size, contact your nearest Victaulic sales representative.

### 4.8 DIMENSIONS

#### Tee Wye

#### No. 32

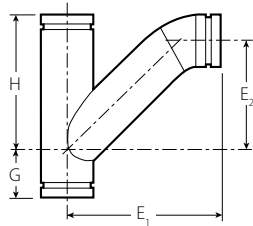

No. 32

Size			No. 32 Tee Wye (sw)				Approx. Weight (Each)		
Nominal inches DN			G inches mm	H inches mm	E <sub>1</sub> inches mm	E <sub>2</sub> inches mm			
2 DN50	x	2 DN50	x	2 DN50	2.75 70	7.00 178	9.00 229	4.63 118	6.4 2.9
2½	x	2½	x	2½	3.00 76	7.75 197	10.50 267	5.75 146	11.5 5.2
3 DN80	x	3 DN80	x	3 DN80	3.25 83	8.50 216	11.50 292	6.50 165	14.3 6.5
3½ DN90	x	3½ DN90	x	3½ DN90	3.25 89	10.00 254	13.00 330	7.75 197	22.9 10.4
4 100	x	4 DN100	x	4 DN100	3.75 95	10.50 267	13.63 346	8.13 207	26.0 11.8
5	x	5	x	5	4.00 102	12.50 318	16.13 410	10.00 254	48.0 21.8
6 DN150	x	6 DN150	x	6 DN150	4.50 114	14.00 356	18.25 464	11.50 292	60.5 27.4
8 DN200	x	8 DN200	x	8 DN200	6.00 152	18.00 457	23.25 591	15.25 387	127.1 57.7
10 DN250	x	10 DN250	x	10 DN250	6.50 165	20.50 521	27.25 692	18.00 457	190.0 86.2
12 DN300	x	12 DN300	x	12 DN300	7.00 178	23.00 584	31.00 787	20.50 521	240.0 108.9

(s) = Carbon Steel Direct Roll Groove (OGS)  
 (sw) = Carbon Steel Segmentally Welded

### 4.9 DIMENSIONS

#### Adapter Nipple

No. 40<sup>12</sup> Grv. x Thd.

No. 42 Grv. x Bev.

No. 43 Grv. x Grv.

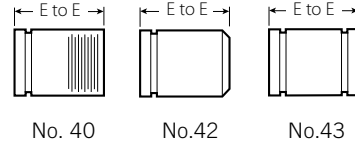

Size		No. 40, 42, 43 Adapter Nipple (s)	
Nominal inches DN	Actual Outside Diameter inches mm	E to E inches mm	Approx. Weight (Each) lb kg
¾ DN20	1.050 26.9	3.00 76	0.3 0.1
1 25	1.315 33.7	3.00 76	0.4 0.2
1¼ DN32	1.660 42.4	4.00 102	0.8 0.4
1½ 40	1.900 48.3	4.00 102	0.9 0.4
2 DN50	2.375 60.3	4.00 102	1.2 0.5
2½	2.875 73.0	4.00 102	1.9 0.9
3 DN80	3.500 88.9	4.00 102	2.5 1.1
3½ DN90	4.000 101.6	4.00 102	2.1 0.9
4 DN100	4.500 114.3	6.00 152	5.5 2.5
5	5.563 141.3	6.00 152	7.4 3.4
6 DN150	6.625 168.3	6.00 152	9.5 4.3
8 DN200	8.625 219.1	6.00 152	14.2 6.4
10 DN250	10.750 273.0	8.00 203	27.0 12.2
12 DN300	12.750 323.9	8.00 203	33.0 15.0

(s) = Carbon Steel Direct Roll Groove (OGS)  
 (sw) = Carbon Steel Segmentally Welded

#### NOTES

- All fittings are ductile iron unless otherwise noted with an (sw) or (s).
- For pump package nipples with 1 ½"/40 mm hole cut to receive Style 923 Vic-Let or Style 924 Vic-O-Well request special No. 40, 42 or 43 nipples and specify No. 40-H, 42-H or 43-H on order. NOTE: 4 – 12"/DN100 – DN300 diameter — 8"/200mm minimum length required.
- For roll grooved systems, Victaulic offers the Advanced Groove System (AGS). For pricing and availability of cut groove fittings in this size, contact your nearest Victaulic sales representative.
- Available with British Standard Pipe Threads, specify "BSP" clearly on order.

## 4.10 DIMENSIONS

### Cap

#### No. 60



No. 60



No. 60

Size		No. 60 Cap	
Nominal	Actual Outside Diameter	"T" Thickness	Approx. Weight (Each)
inches DN	inches mm	inches mm	lb kg
¾	1.050	0.88	0.2
DN20	26.9	22	0.1
1	1.315	0.88	0.3
25	33.7	22	0.1
1¼	1.660	0.88	0.3
DN32	42.4	22	0.1
1½	1.900	0.88	0.5
DN40	48.3	22	0.2
2	2.375	0.88	0.6
DN50	60.3	22	0.3
2½	2.875	0.88	1.0
	73.0	22	0.5
DN65	3.000	0.88	1.2
	76.1	22	0.5
3	3.500	0.88	1.2
DN80	88.9	22	0.5
3½	4.000	0.88	2.5
DN90	101.6	22	1.1
	4.250	1.00	2.3
	108.0	25	1.0
4	4.500	1.00	2.5
DN100	114.3	25	1.1
	5.250	1.00	4.5
	133.0	25	2.0
DN125	5.500	1.00	4.5
	139.7	25	2.0
5	5.563	1.00	4.6
	141.3	25	2.1

Size		No. 60 Cap	
Nominal	Actual Outside Diameter	"T" Thickness	Approx. Weight (Each)
inches DN	inches mm	inches mm	lb kg
	6.250	1.00	6.8
	159.0	25	3.1
	6.500	1.00	7.3
	165.1	25	3.3
6	6.625	1.00	6.1
DN150	168.3	25	2.8
8	8.625	1.19	13.1
DN200	219.1	30	5.9
10	10.750	1.25	21.0
DN250	273.0	32	9.5
12	12.750	1.25	35.6
DN300	323.9	32	16.2
14 <sup>2</sup>	14.000	9.50 (s)	+
DN350	355.6	241	
16 <sup>2</sup>	16.000	10.00 (s)	+
DN400	406.4	254	
18 <sup>2</sup>	18.000	11.00 (s)	+
DN450	457.0	279	
20 <sup>2</sup>	20.000	12.00 (s)	+
DN500	508.0	305	
24 <sup>2</sup>	24.000	13.50 (s)	+
DN600	610.0	343	
14 – 60 DN350 – DN1500	For AGS fitting information, see <a href="#">publication 20.05</a>		



<sup>2</sup> For 14"/DN350 and larger roll grooved systems, Victaulic offers the Advanced Groove System (AGS). For pricing and availability of cut groove fittings in this size, contact your nearest Victaulic sales representative.

(s) = Carbon Steel Direct Roll Groove (OGS)

(sw) = Carbon Steel Segmentally Welded

+ Contact Victaulic for details.

#### NOTES

- No. 60 cap is not suitable for use in vacuum service with Style 72 or 750 couplings. No. 61 bull plugs should be used.
- All fittings are ductile iron unless otherwise noted with an (sw) or (s).



## 4.11 DIMENSIONS

### Flanged Adapter Nipple

No. 41 ANSI Class 125

No. 45F ANSI Class 150 Flat Face

No. 45R ANSI Class 150 Raised Face

No. 46F ANSI Class 300 Flat Face

No. 46R ANSI Class 300 Raised Face

No. 45RE PN10/PN16 Raised Face

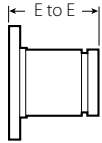

No. 41

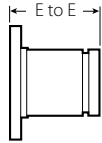

No. 45F

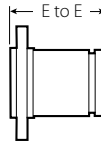

No. 45R

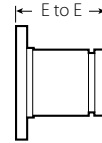

No. 46F

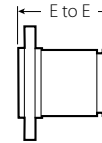

No. 46R

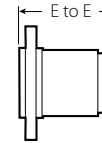

No. 45RE

Size		No. 41 ANSI 125 Flange Adapter Nipple		No. 45F and No. 45R ANSI 150 Flanged Adapter Nipple (s)		No. 46F and No. 46R ANSI 300 Flanged Adapter Nipple (s)		No. 45RE Flanged Adapter Nipple	
Nominal inches DN	Actual Outside Diameter inches mm	E to E inches mm	Approx. Weight (Each) lb kg	E to E inches mm	Approx. Weight (Each) lb kg	E to E inches mm	Approx. Weight (Each) lb kg	E to E inches mm	Approx. Weight (Each) lb kg
¾ DN20	1.050 26.9	3.00 76	—	3.00 76	2.3 1.0	3.00 76	3.3 1.5	—	—
1 DN25	1.315 33.7	3.00 76	2.5 1.1	3.00 76	2.7 1.2	3.00 76	3.9 1.8	—	—
1¼ DN32	1.660 42.4	4.00 102	3.0 1.4	4.00 102	3.3 1.5	4.00 102	4.8 2.2	—	—
1½ DN40	1.900 48.3	4.00 102	3.5 1.6	4.00 102	3.9 1.8	4.00 102	6.9 3.1	—	—
2 DN50	2.375 60.3	4.00 102	5.5 2.5	4.00 102	6.0 2.7	4.00 102	8.2 3.7	2.50 64	5.3 2.4
2½	2.875 73.0	4.00 102	8.0 3.6	4.00 102	9.9 4.5	4.00 102	11.9 5.4	—	—
DN65	3.000 76.1	—	—	—	—	—	—	2.50 64	6.5 2.9
3 DN80	3.500 88.9	4.00 102	9.5 4.3	4.00 102	11.7 5.3	4.00 102	16.5 7.5	2.50 64	8.2 3.7
3½ DN90	4.000 101.6	4.00 102	12.0 5.4	4.00 102	15.1 6.8	4.00 102	20.1 9.1	—	—
4 DN100	4.500 114.3	6.00 152	16.7 7.6	6.00 152	18.5 8.4	6.00 152	27.4 12.4	2.75 70	10.0 45
5	5.563 141.3	6.00 152	21.5 9.8	6.00 152	21.3 9.7	6.00 152	35.3 16.0	—	—
DN125	5.500 139.7	—	—	—	—	—	—	2.75 70	16.3 7.4
6 DN150	6.625 168.3	6.00 152	26.5 12.0	6.00 152	27.5 12.5	6.00 152	47.5 21.5	2.75 70	16.3 7.4
	6.500 165.1	—	—	—	—	—	—	—	—
8 DN200	8.625 219.1	6.00 152	39.0 17.7	6.00 152	41.3 18.8	6.00 152	70.3 31.9	—	—
10 DN250	10.750 273.0	8.00 203	57.0 25.9	8.00 203	59.3 27.1	8.00 203	100.8 45.7	—	—
12 DN300	12.750 323.9	8.00 203	41.0 18.6	8.00 203	40.0 40.0	8.00 203	146.2 66.3	—	—
14 <sup>2</sup> DN350	14.000 355.6	8.00 203	—	8.00 203	+	8.00 203	+	—	—
16 <sup>2</sup> DN400	16.000 406.4	8.00 203	—	8.00 203	+	8.00 203	+	—	—
18 <sup>2</sup> DN450	18.000 457.0	8.00 203	—	8.00 203	+	8.00 203	+	—	—

<sup>2</sup> For 14"/DN350 and larger roll grooved systems, Victaulic offers the Advanced Groove System (AGS). For pricing and availability of cut groove fittings in this size, contact your nearest Victaulic sales representative.

(s) = Carbon Steel Direct Roll Groove (OGS)

(sw) = Carbon Steel Segmentally Welded

### 4.11 DIMENSIONS (Continued)

#### Flanged Adapter Nipple

No. 41 ANSI Class 125

No. 45F ANSI Class 150 Flat Face

No. 45R ANSI Class 150 Raised Face

No. 46F ANSI Class 300 Flat Face

No. 46R ANSI Class 300 Raised Face

No. 45RE PN10/PN16 Raised Face

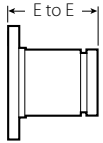

No. 41

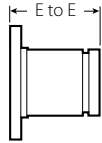

No. 45F

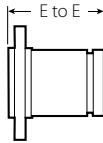

No. 45R

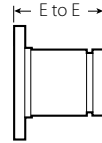

No. 46F

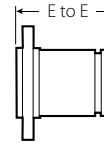

No. 46R

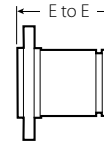

No. 45RE

Size		No. 41 ANSI 125 Flange Adapter Nipple		No. 45F and No. 45R ANSI 150 Flanged Adapter Nipple (s)		No. 46F and No. 46R ANSI 300 Flanged Adapter Nipple (s)		No. 45RE Flanged Adapter Nipple (s)	
Nominal inches DN	Actual Outside Diameter inches mm	E to E inches mm	Approx. Weight (Each) lb kg	E to E inches mm	Approx. Weight (Each) lb kg	E to E inches mm	Approx. Weight (Each) lb kg	E to E inches mm	Approx. Weight (Each) lb kg
20 <sup>2</sup> DN500	20.000 508.0	8.00 203	—	8.00 203	+	8.00 203	+	—	—
24 <sup>2</sup> DN600	24.000 610.0	8.00 203	—	8.00 203	+	8.00 203	+	—	—
14 – 60 DN350 – DN1500	For AGS fitting information, see <a href="#">publication 20.05</a> 								

<sup>2</sup> For 14"/DN350 and larger roll grooved systems, Victaulic offers the Advanced Groove System (AGS). For pricing and availability of cut groove fittings in this size, contact your nearest Victaulic sales representative.

(s) = Carbon Steel Direct Roll Groove (OGS)

(sw) = Carbon Steel Segmentally Welded

+ Contact Victaulic for details

**NOTE**

- All fittings are ductile iron unless otherwise noted with an (sw) or (s).

## 4.12 DIMENSIONS

### Swaged Nipple

No. 53 Grv. x Grv.

No. 54 Grv. x Thd.

No. 55 Thd. x Grv.

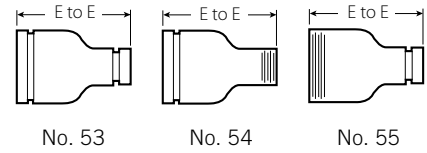
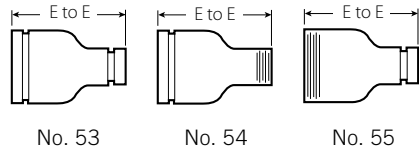

Size			No. 53, 54, and 55 Swaged Nipples (s)	
Nominal inches DN			E to E inches mm	Approx. Weight (Each) lb kg
2 DN50	x	1 DN25	6.50 165	2.0 0.9
		1¼ DN32	6.50 165	2.0 0.9
		1½ DN40	6.50 165	2.0 0.9
2½	x	1 DN25	7.00 178	3.0 1.4
		1¼ DN32	7.00 178	3.0 1.4
		1½ DN40	7.00 178	3.0 1.4
		2 DN50	7.00 178	3.0 1.4
3 DN80	x	1 DN25	8.00 203	4.5 2.0
		1¼ DN32	8.00 203	4.5 2.0
		1½ DN40	8.00 203	4.5 2.0
		2 DN50	8.00 203	4.5 2.0
		2½	8.00 203	4.5 2.0
3½ DN90	x	3 DN80	8.00 203	6.8 3.1
4 DN100	x	1 DN25	9.00 229	7.5 3.4
		1¼ DN32	9.00 229	7.5 3.4
		1½ DN40	9.00 229	7.5 3.4
		2 DN50	9.00 229	7.5 3.4
		2½	9.00 229	7.5 3.4
		3 DN80	9.00 229	7.5 3.4
		3½ DN90	9.00 229	7.5 3.4

Size			No. 53, 54, and 55 Swaged Nipples (s)	
Nominal inches DN			E to E inches mm	Approx. Weight (Each) lb kg
5	x	2 DN50	11.00 279	11.5 5.2
		3 DN80	11.00 279	11.3 5.1
		4 DN100	11.00 279	11.5 5.2
6 DN150	x	1 DN25	12.00 305	17.0 7.7
		1¼ DN32	12.00 305	17.0 7.7
		1½ DN40	12.00 305	17.2 7.8
		2 DN50	12.00 305	17.4 7.9
		2½	12.00 305	17.4 7.9
		3 DN80	12.00 305	17.4 7.9
		3½ DN90	12.00 305	17.4 7.9
		4 DN100	12.00 305	17.5 7.9
		4½	12.00 305	17.5 7.9
		5	12.00 305	17.5 7.9
		8 DN200	x	6 DN150

(s) = Carbon Steel Direct Roll Groove (OGS)

(sw) = Carbon Steel Segmentally Welded

+ Contact Victaulic for details

**NOTE**

- All fittings are ductile iron unless otherwise noted with an (sw) or (s).

### 4.13 DIMENSIONS

#### Female Threaded Adapter

##### No. 80

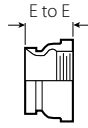

No. 80

Size		No. 80 Female Threaded Adapter	
Nominal inches DN	Actual Outside Diameter inches mm	E to E inches mm	Approx. Weight (Each) lb kg
¾ DN20	1.050 26.9	2.00 51	1.0 0.5
1 DN25	1.315 33.7	2.06 52	1.0 0.5
1¼ DN32	1.660 42.4	2.31 (sw) 59	1.5 0.7
1½ DN40	1.900 48.3	2.31 (sw) 59	1.5 0.7
2 DN50	2.375 60.3	2.50 64	1.4 0.6
2½	2.875 73.0	2.75 70	1.5 0.7
3 DN80	3.500 88.9	2.75 70	2.9 1.3
4 DN100	4.500 114.3	3.25 83	4.5 2.0

(s) = Carbon Steel Direct Roll Groove (OGS)

(sw) = Carbon Steel Segmentally Welded

#### NOTES

- Available with British Standard Pipe Threads, specify "BSP" clearly on order.
- All fittings are ductile iron unless otherwise noted with an (sw) or (s).

### 4.14 DIMENSIONS

#### Hose Nipple

##### No. 48

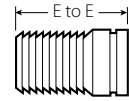

No. 48

Size		No. 48 Hose Nipple (s)	
Nominal inches DN	Actual Outside Diameter inches mm	E to E inches mm	Approx. Weight (Each) lb kg
¾ DN20	1.050 26.9	3.12 79	0.3 0.1
1 DN25	1.315 33.7	3.38 86	0.4 0.2
1¼ DN32	1.660 42.4	3.88 98	0.6 0.3
1½ DN40	1.900 48.3	3.88 98	0.8 0.4
2 DN50	2.375 60.3	4.50 114	1.1 0.5
2½	2.875 73.0	5.38 137	2.0 0.9
3 DN80	3.500 88.9	5.75 146	3.2 1.5
4 DN100	4.500 114.3	7.00 178	4.9 2.2
5	5.563 141.3	8.75 222	8.0 3.6
6 DN150	6.625 168.3	10.13 257	14.3 6.5
8 DN200	8.625 219.1	11.88 302	24.7 11.2
10 DN250	10.750 273.0	12.50 318	40.1 18.2
12 DN300	12.750 323.9	14.50 368	62.0 28.1

(s) = Carbon Steel Direct Roll Groove (OGS)

(sw) = Carbon Steel Segmentally Welded

#### NOTE

- All fittings are ductile iron unless otherwise noted with an (sw) or (s).

## 4.15 DIMENSIONS

### Concentric/Eccentric Reducer

No. 50 Concentric

No. 51 Eccentric

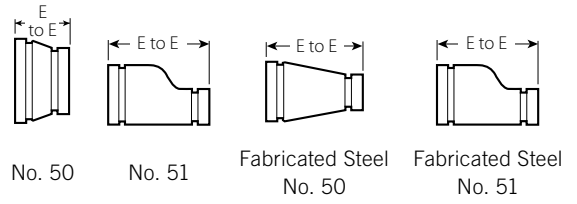
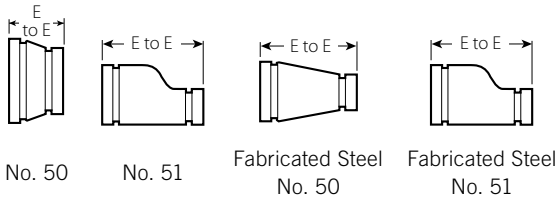

Size	No. 50 Concentric Reducer			No. 51 Eccentric Reducer	
	Nominal inches DN	E to E inches mm	Approx. Weight (Each) lb kg	E to E inches mm	Approx. Weight (Each) lb kg
1 1/4 DN32 x 3/4 DN20	+	1.9 0.9	—	—	
	1 DN25	+	1.9 0.9	—	—
1 1/2 DN40 x 3/4 DN20	+	1.4 0.6	—	—	
	1 DN25	2.50 64	0.8 0.4	8.50 (sw) 216	4.5 2.0
	1 1/4 DN32	2.50 64	1.0 0.5	—	—
2 DN50 x 3/4 DN20	2.50 64	0.9 0.3	9.00 (sw) 229	2.0 0.9	
	1 DN25	2.50 64	0.7 0.3	9.00 (sw) 229	2.3 1.0
	1 1/4 DN32	2.50 64	1.2 0.5	9.00 (sw) 229	4.6 2.1
	1 1/2 DN40	2.50 64	1.0 0.5	3.50 89	1.1 0.5
2 1/2 x 3/4 DN20	+	1.3 0.6	+	3.3 1.5	
	1 DN25	2.50 64	1.1 0.5	9.50 241	3.5 1.6
	1 1/4 DN32	3.50 89	3.3 1.5	3.50 89	1.4 0.6
	1 1/2 DN40	2.50 64	3.6 1.6	9.50 (sw) 241	3.7 1.7
	2 DN50	2.50 64	3.9 1.8	3.50 89	4.3 2.0
	3 DN80 x 3/4 DN20	+	1.5 0.7	+	4.5 2.0
1 DN25	2.50 64	1.3 0.6	9.50 (sw) 241	4.8 2.2	
	1 1/4 DN32	2.50 64	1.4 0.6	+	4.8 2.2
	1 1/2 DN40	2.50 64	5.1 2.3	9.50 (sw) 241	5.1 2.3
	2 DN50	2.50 64	1.6 0.7	3.50 89	6.0 2.7
	2 1/2 DN65	2.50 64	1.8 0.8	3.50 89	7.0 3.2
	3 DN80	2.50 64	2.0 0.9	9.50 (sw) 241	7.0 3.2
3 1/2 DN90 x 3 DN80	64	2.0 0.9	9.50 (sw) 241	7.0 3.2	
	1 DN25	3.00 76	3.0 1.4	13.00 (sw) 330	6.5 2.9

Size	No. 50 Concentric Reducer			No. 51 Eccentric Reducer	
	Nominal inches DN	E to E inches mm	Approx. Weight (Each) lb kg	E to E inches mm	Approx. Weight (Each) lb kg
1 1/4 DN32	+	4.6 2.1	—	—	
	1 1/2 DN40	3.00 (sw) 76	2.6 1.2	10.00 (sw) 254	8.1 3.7
	2 DN50	3.00 76	2.4 1.1	4.00 102	3.3 1.5
	2 1/2	3.00 76	2.7 1.2	4.00 102	3.4 1.5
	3 DN80	3.00 76	3.2 1.4	4.00 102	3.5 1.6
	3 1/2 DN90	3.00 76	2.9 1.3	10.00 (sw) 254	8.0 3.6
	5 x 2 DN50	11.00 (sw) 279	9.0 4.1	11.00 (sw) 279	5.2 2.4
2 1/2		4.00 102	4.3 2.0	11.00 (sw) 279	10.8 4.9
3 DN80		4.00 102	5.5 2.5	11.00 (sw) 279	11.1 5.0
4 DN100		3.50 89	4.3 1.9	5.00 127	12.0 5.4
6 DN150 x 1 DN25	4.00 102	5.0 2.3	11.50 (sw) 292	14.5 6.6	
	1 1/2 DN40	+	5.5 2.5	+	+
	2 DN50	4.00 102	6.6 3.0	11.50 (sw) 292	14.5 6.6
	2 1/2	4.00 102	6.4 2.9	11.50 (sw) 292	14.2 6.4
	3 DN80	4.00 102	6.4 2.9	5.50 140	15.0 6.8
	4 DN100	4.00 102	6.5 2.9	5.50 140	17.0 7.7
	5	4.00 102	6.4 2.9	5.50 140	17.0 7.7
8 DN200 x 2 1/2	16.00 406	7.9 3.6	12.00 (sw) 305	26.1 11.8	
	3 DN80	5.00 127	9.3 4.2	12.00 (sw) 305	22.0 10.0
	4 DN100	5.00 127	10.4 4.8	12.00 (sw) 305	23.0 10.4
	5	5.00 127	11.6 5.2	12.00 (sw) 305	23.0 10.4
	6 DN150	5.00 127	11.9 5.4	6.00 152	24.0 10.9

### 4.15 DIMENSIONS (Continued)

#### Concentric/Eccentric Reducer

No. 50 Concentric

No. 51 Eccentric

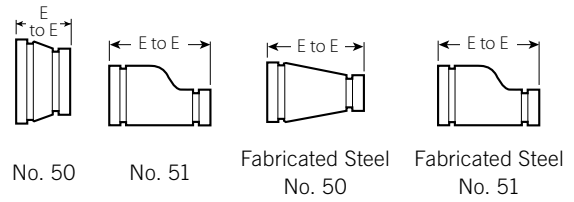
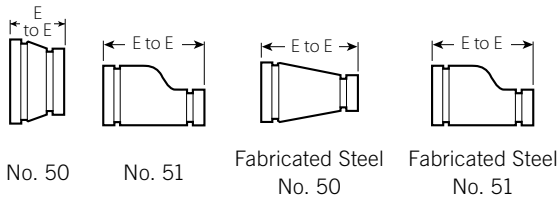

Size	No. 50 Concentric Reducer			No. 51 Eccentric Reducer	
	Nominal inches DN	E to E inches mm	Approx. Weight (Each) lb kg	E to E inches mm	Approx. Weight (Each) lb kg
10 DN250 x 4 DN100	5	+	33.0 15.0	+	34.6 15.7
	6 DN150	6.00 152	20.0 9.1	13.00 (sw) 330	36.9 16.7
	8 DN200	6.00 152	22.0 10.0	7.00 178	21.6 9.8
	12 DN300 x 4 DN100	+	44.0 20.0	14.00 (sw) 356	48.0 21.8
12 DN300 x 6 DN150	8 DN200	7.00 178	24.6 11.2	14.00 (sw) 356	50.0 22.7
	10 DN250	7.00 178	39.0 17.7	14.00 (sw) 356	57.0 25.9
	14 <sup>2</sup> DN350 x 6 DN150	13.00 330	65.0 29.5	13.00 330	60.0 27.2
	8 DN200	13.00 330	65.0 29.5	13.00 330	60.0 27.2
14 <sup>2</sup> DN350 x 10 DN250	12 DN300	13.00 330	68.0 30.8	13.00 330	66.0 29.9
	16 <sup>2</sup> DN400 x 8 DN200	14.00 356	73.0 33.1	14.00 355	73.0 33.1
	10 DN250	14.00 356	73.0 33.1	14.00 355	73.0 33.1
	12 DN300	14.00 356	73.0 33.1	14.00 355	73.0 33.1
14 DN350 x 14 DN350	14 DN350	14.00 356	73.0 33.1	14.00 355	73.0 33.1
	18 <sup>2</sup> DN450 x 10 DN250	15.00 381	91.0 41.3	15.00 381	91.0 41.3
	12 DN300	15.00 381	91.0 41.3	15.00 381	91.0 41.3
	14 DN350	15.00 381	91.0 41.3	15.00 381	91.0 41.3
16 DN400 x 16 DN400	16 DN400	15.00 381	91.0 41.3	15.00 381	91.0 41.3

Size	No. 50 Concentric Reducer		No. 51 Eccentric Reducer		
	Nominal inches DN	E to E inches mm	Approx. Weight (Each) lb kg	E to E inches mm	Approx. Weight (Each) lb kg
20 <sup>2</sup> DN500 x 10 DN250	12 DN300	20.00 508	120.0 54.4	20.00 508	120.0 54.4
	14 DN350	20.00 508	149.0 67.9	20.00 508	149.0 67.9
	16 DN400	20.00 508	120.0 54.4	20.00 508	120.0 54.4
	18 DN450	20.00 508	136.0 61.7	20.00 508	136.0 61.7
	24 <sup>2</sup> DN600 x 10 DN250	20.00 508	142.0 64.4	20.00 508	142.0 64.4
12 DN300	12 DN300	20.00 508	150.0 68.0	20.00 508	150.0 68.0
	14 DN350	20.00 508	162.0 73.5	20.00 508	162.0 73.5
	16 DN400	20.00 508	162.0 73.5	20.00 508	162.0 73.5
	18 DN450	20.00 508	162.0 73.5	20.00 508	162.0 73.5
	20 DN500	20.00 508	151.0 68.5	20.00 508	190.0 86.2
14 – 60 DN350 – DN1500	For AGS fitting information, see <a href="#">publication 20.05</a>				



<sup>2</sup> For 14"/DN350 and larger roll grooved systems, Victaulic offers the Advanced Groove System (AGS). For pricing and availability of cut groove fittings in this size, contact your nearest Victaulic sales representative.

(s) = Carbon Steel Direct Roll Groove (OGS)

(sw) = Carbon Steel Segmentally Welded

+ Contact Victaulic for details.

**NOTES**

- Available with male threaded small end No. 52.
- Cast fitting available for JIS size. Contact Victaulic for details.
- Steel eccentric reducers available through 30"/DN750, contact Victaulic for dimensions.
- All fittings are ductile iron unless otherwise noted with an (sw) or (s).

<sup>2</sup> For 14"/DN350 and larger roll grooved systems, Victaulic offers the Advanced Groove System (AGS). For pricing and availability of cut groove fittings in this size, contact your nearest Victaulic sales representative.

## 4.16 DIMENSIONS

### Small Threaded Reducer

No. 52

No. 52F



No. 52



No. 52F



No. 52



No. 52F

Size		No. 52 Small Threader Reducer		No. 52F Concentric Reducer with BSPT Female Threaded End	
Nominal inches DN		E to E inches mm	Approx. Weight (Each) lb kg	E to E mm	Approx. Weight (Each) kg
1½ DN40	x 1 DN25	2.50 64	0.8 0.4	—	—
	x ¼ DN32	2.50 64	0.9 0.4	—	—
2 DN50	x ¾ DN20	2.50 64	0.9 0.4	—	—
	x 1 DN25	2.50 64	0.7 0.3	—	—
	x ¼ DN32	2.50 64	1.2 0.5	—	—
	x ½ DN40	2.50 64	1.0 0.5	—	—
2½	x 1 DN25	2.50 64	1.1 0.5	—	—
	x ¼ DN32	2.50 (sw) 64	1.2 0.5	—	—
	x ½ DN40	2.50 (sw) 64	1.3 0.6	—	—
	x 2 DN50	2.50 64	1.4 0.6	—	—
DN65	x ½ DN40	64	0.8	64	0.8
	x 2 DN50	—	—	64	0.9
3 DN80	x ¾ DN20	+(sw)	1.5 0.7	—	—
	x 1 DN25	2.50 64	1.3 0.6	—	—
	x ¼ DN32	2.50 64	1.5 0.7	—	—
	x ½ DN40	2.50 (sw) 64	1.5 0.7	—	—
	x 2 DN50	2.50 64	1.5 0.7	—	—
	x 2½	2.50 64	2.4 1.1	—	—
88.9mm	x 42.4mm	64	0.9	64	0.8
	x 48.3mm	64	0.9	64	0.9
	x 60mm	—	—	64	0.9

(s) = Carbon Steel Direct Roll Groove (OGS)

(sw) = Carbon Steel Segmentally Welded

+ Contact Victaulic for details.

Size		No. 52 Small Threader Reducer		No. 52F Concentric Reducer with BSPT Female Threaded End	
Nominal inches DN		E to E inches mm	Approx. Weight (Each) lb kg	E to E mm	Approx. Weight (Each) kg
4 DN100	x 1 DN25	3.00 76	2.3 1.0	—	—
	x ½ DN40	3.00 76	2.7 1.2	—	—
	x 2 DN50	3.00 76	2.6 1.2	—	—
	x 2½	3.00 76	2.6 1.2	—	—
	x 3 DN80	3.00 76	2.5 1.1	—	—
108.0mm	x 42.4mm	76	1.3	76	1.3
	x 48.3mm	76	1.3	76	1.4
	x 60mm	—	—	76	1.4
114.3mm	x 42.4mm	76	1.3	76	1.3
	x 48.3mm	76	1.3	76	1.3
	x 60mm	76	1.3	76	1.4
5	x 4 DN100	+	4.5 2.0	—	—
	x 60mm	—	—	114	2.2
139.0mm	x 60mm	—	—	114	2.3
6 DN150	x 1 DN25	4.00 102	5.5 2.5	—	—
	x 2 DN50	4.00 102	5.7 2.6	—	—
	x 2½	4.00 102	5.8 2.6	—	—
	x 3 DN80	4.00 102	5.8 2.6	—	—
	x 4 DN100	+(sw)	6.5 2.9	—	—
	x 5	+(sw)	2.0 0.9	—	—
159.0mm	x 42.4mm	114	2.2	144	2.5
	x 48.3mm	114	2.2	114	2.5
	x 60mm	—	—	114	2.6

## 4.16 DIMENSIONS (Continued)

### Small Threaded Reducer

No. 52

No. 52F



No. 52



No 52F

Size	No. 52 Small Threader Reducer		No. 52F Concentric Reducer with BSPT Female Threaded End		
	Nominal inches DN	E to E inches mm	Approx. Weight (Each) lb kg	E to E mm	Approx. Weight (Each) kg
165.1mm x 42.4mm	48.3mm	102mm	2.4	102	2.9
	60mm	—	—	102	3.0
	8 DN200 x 2 DN50	16.00 406	1.5 0.7	—	—
	2 ½	16.00 406	1.7 0.8	—	—

(s) = Carbon Steel Direct Roll Groove (OGS)

(sw) = Carbon Steel Segmentally Welded

#### NOTES

- Available with British Standard Pipe Threads, specify “BSP” clearly on order.
- All fittings are ductile iron unless otherwise noted with an (sw) or (s).



## 5.0 PERFORMANCE

### Flow Data

#### (Frictional Resistance)

The chart expresses the frictional resistance of various Victaulic fittings as equivalent feet of straight pipe. Fittings not listed can be estimated from the data given, for example, a 22½° elbow is approximately one-half the resistance of a 45° elbow. Values of mid-sizes can be interpolated.

Size		Dimensions					
Nominal inches DN	Actual Outside Diameter inches mm	90° Elbows		45° Elbows		Tees	
		No. 10 Std. Radius feet meters	No. 100 1 ½ D Long Radius feet meters	No. 11 Std. Radius feet meters	No. 110 1 ½ D Long Radius feet meters	Branch feet meters	Run feet meters
1 DN25	1.315 33.7	1.7 0.5	—	0.8 0.2	—	4.2 1.3	1.7 0.5
2 DN50	2.375 60.3	3.5 1.1	2.5 0.8	1.8 0.5	1.1 0.3	8.5 2.6	3.5 1.1
DN65	3.000 76.1	4.3 1.3	—	2.1 0.7	—	10.8 3.3	4.3 1.3
3 DN80	3.500 88.9	5.0 1.5	3.8 1.2	2.6 0.8	1.6 0.5	13.0 4.0	5.0 1.5
	4.250 108.0	6.4 2.0	—	3.2 0.9	—	15.3 4.7	6.4 2.0
4 DN100	4.500 114.3	6.8 2.1	5.0 1.5	3.4 1.0	2.1 0.6	16.0 4.9	6.8 2.1
	5.250 133.0	8.1 2.5	—	4.1 1.2	—	20.0 6.2	8.1 2.5
DN125	5.500 139.7	8.5 2.6	—	4.2 1.3	—	21.0 6.4	8.5 2.6
5	5.563 141.3	8.5 2.6	—	4.2 1.3	—	21.0 6.4	8.5 2.6
	6.250 159.0	9.4 2.9	—	4.9 1.5	—	25.0 7.6	9.6 2.9
	6.500 165.1	9.6 2.9	—	5.0 1.5	—	25.0 7.6	10.0 3.0
6 DN150	6.625 168.3	10.0 3.0	7.5 2.3	5.0 1.5	3.0 0.9	25.0 7.6	10.0 3.0
8 DN200	8.625 219.1	13.0 4.0	9.8 3.0	6.5 2.0	4.0 1.2	33.0 10.1	13.0 4.0
10 DN250	10.750 273.0	17.0 5.2	12.0 3.7	8.3 2.5	5.0 1.5	41.0 12.5	17.0 5.2
12 DN300	12.750 323.9	20.0 6.1	14.5 4.4	10.0 3.0	6.0 1.8	50.0 15.2	20.0 6.1
14 DN350	14.000 355.6	24.5 <sup>4</sup> 7.5	15.8 4.8	18.5 <sup>4</sup> 5.6	11.0 3.4	70.0 21.3	23.0 7.0
16 DN400	16.000 406.4	28.0 <sup>4</sup> 8.5	18.0 5.5	21.0 <sup>4</sup> 6.4	13.0 4.0	80.0 24.4	27.0 8.2
18 DN450	18.000 457.0	31.0 <sup>4</sup> 9.5	20.0 6.1	23.5 <sup>4</sup> 7.2	14.0 4.3	90.0 27.4	30.0 9.1
20 DN800	20.000 508.0	34.0 <sup>4</sup> 10.4	22.5 6.9	25.5 <sup>4</sup> 7.8	16.0 4.9	100.0 30.5	33.0 10.1
24 DN600	24.000 610.0	42.0 <sup>4</sup> 12.8	27.0 8.2	29.5 <sup>4</sup> 9.0	19.0 5.8	120.0 36.6	40.0 12.2

AGS fittings available up to 60"/DN1500. Contact Victaulic for details.



<sup>4</sup> Fitting flow data for 14-24"/DN350-DN600 size No. 10 and No. 11 Elbows is based on fittings for Style 07 and 77 couplings. For flow data on AGS fittings (No. W10 and No. W11 Elbows), refer to [publication 20.05](#).

---

**User Responsibility for Product Selection and Suitability**

Each user bears final responsibility for making a determination as to the suitability of Victaulic products for a particular end-use application, in accordance with industry standards and project specifications, and the applicable building codes and related regulations as well as Victaulic performance, maintenance, safety, and warning instructions. Nothing in this or any other document, nor any verbal recommendation, advice, or opinion from any Victaulic employee, shall be deemed to alter, vary, supersede, or waive any provision of Victaulic Company's standard conditions of sale, installation guide, or this disclaimer.

**Intellectual Property Rights**

No statement contained herein concerning a possible or suggested use of any material, product, service, or design is intended, or should be constructed, to grant any license under any patent or other intellectual property right of Victaulic or any of its subsidiaries or affiliates covering such use or design, or as a recommendation for the use of such material, product, service, or design in the infringement of any patent or other intellectual property right. The terms "Patented" or "Patent Pending" refer to design or utility patents or patent applications for articles and/or methods of use in the United States and/or other countries.

**Note**

This product shall be manufactured by Victaulic or to Victaulic specifications. All products to be installed in accordance with current Victaulic installation/assembly instructions. Victaulic reserves the right to change product specifications, designs and standard equipment without notice and without incurring obligations.

**Installation**

Reference should always be made to the Victaulic installation handbook or installation instructions of the product you are installing. Handbooks are included with each shipment of Victaulic products, providing complete installation and assembly data, and are available in PDF format on our website at [www.victaulic.com](http://www.victaulic.com).

**Warranty**

Refer to the Warranty section of the current Price List or contact Victaulic for details.

**Trademarks**

*Victaulic* and all other Victaulic marks are the trademarks or registered trademarks of Victaulic Company, and/or its affiliated entities, in the U.S. and/or other countries.